



Undergraduate Open Day 2017

Friday 23 and
Saturday 24 June

Canary Wharf

Brick Lane

Tech City

Shoreditch

Stepney Green

94%

GRADUATES IN
EMPLOYMENT OR
FURTHER STUDY
(DLHE 2015)

9th
in the UK
for research
REF 2014

BARTS &
THE LONDON

MILE END

Post your best
selfie to be in
with the chance
of winning £50
Amazon vouchers!



@QMUL



QMUL



OfficialQMUL

#futureqmul

#qmul,

#qmulopenday,

#qmulselfie

QMUL

Welcome from the Principal



I am delighted to welcome you to the Queen Mary University of London Open Day. This is our chance to show you what life is like as a member of the Queen Mary Community.

You will have the opportunity to explore our campus, to view our superb Student Village and to see some of the excellent teaching facilities, in which we have invested over £250 million in recent years. You will also get a feel for the social life and extra-curricular activities on offer at Queen Mary and meet representatives from our lively and engaged Students' Union.

You will have the chance to talk to staff: to our academics, whose dedication to their teaching is so much appreciated by our students, and whose research has taken us to membership of the Russell Group of leading UK universities, and to increasing international stature; and to the professional services staff who do so much to support students during their time with us.

Finally, and perhaps most importantly, you will be able to speak to Queen Mary students, who enjoy one of the best student experiences in London (ranked top in London amongst Russell Group universities for student satisfaction in 2016 National Student Survey), and find out all you need to know about studying at one of central London's largest campus universities. So please, relax, explore and make yourself at home; but most of all enjoy your day with us.

Professor Simon Gaskell
Principal

Contents

Welcome	2
About our Open Day	3
Subject Talks Schedule	4
Taster Lectures Schedule	6
Campus Map and Academic Welcome Areas	8
Subject Areas	10
Student Experience Fair	11
Tours and Activities	12
Scholarships and Bursaries	13
Parents and Carers Guide	14
Investing in your Future	15
Celebrating 130 years	16
Student Union	18
Get Active - Sport at Queen Mary	19
Student Accommodation	20
Our Location	21
World Food Festival	22
Top 5 things to do and Open Day planner	23



"Open Day at QMUL was a great experience, not just for me, but also for my family"

Any section of this publication is available in large print upon request. If you require this publication in a different accessible format we will endeavour to provide this where possible. For further information and assistance, please contact: designandbranding@qmul.ac.uk.

About Our Open Day

We know that when you first arrive at an Open Day, it can be quite overwhelming. There are people everywhere, timetables, maps, and signs pointing in all directions. It's a lot to take in!

As a starting point, please read this page, which tells you a bit more about the Open Day in general. The rest of the programme gives you all the information you need to plan your day: what's happening where and when.

If you need help at any point during the day, please have a chat with one of our Student Ambassadors or staff members, who will be happy to assist you.



Opening Hours

The Open Day is open between 9.45am-4pm. All talks are offered on a first-come, first-served basis. You are welcome to attend any talks and activities in any subject area, not just the one you indicated in at the time of booking. Once you have checked in you are free to come and go from the Open Day as it suits you.



Information Point

Staff and Student Ambassadors are stationed throughout the campus if you require any information, advice or guidance. Look out for our blue and purple t-shirts!

The information point is also open all day in Library Square for any questions you have.



General Information

Smoking is only permitted in the signed designated areas on the Mile End campus.

If a fire alarm sounds, please follow the instructions from staff and Student Ambassadors in order to leave the building safely.

Toilets are available in most buildings and extra portable toilets around the campus. Please ask staff for directions. Please alert a member of staff if you require first aid.



Campus Map

To make it easier for you to find where you need to go, the campus map, talks timetables and Welcome Areas are colour coded.

For instance, if a talk is coloured yellow, that's the ArtsOne Building, so just find the yellow building on the map and make your way there through the campus.



Free tea and coffee

Free tea and coffee can be enjoyed in the Octagon all day.

HUB

The Students' Union Hub is home to the Union's activities, reception, social space and prayer room in the Multi-Faith Centre.



Food Festival

Food can be bought from the World Food Festival located by the canal and Graduate Centre Square where you will find a selection of treats from around the world.



Talks

GENERAL INTEREST TALKS								
	10:00-10:30	10:45-11:15	11:30-12:00	12:15-12:45	13:00-13:30	13:45-14:15	14:30-15:00	15:15-15:45
Principal's Welcome	People's Palace Great Hall				People's Palace Great Hall			
Residential Life				Drapers' Lecture Theatre		Drapers' Lecture Theatre		
Student Finance		People's Palace Skeel Theatre					People's Palace Skeel Theatre	
Student Life			G.O. Jones Lecture Theatre				G.O. Jones Lecture Theatre	
Industrial Experience for Science and Engineering Students			Francis Bancroft David Sizer Theatre				Francis Bancroft David Sizer Theatre	
Careers and Employability		Francis Bancroft David Sizer Theatre				Francis Bancroft David Sizer Theatre		
Admissions and UCAS Application Process			People's Palace Skeel Theatre					People's Palace Skeel Theatre
Global Opportunities					Francis Bancroft David Sizer Theatre			

SUBJECT TALKS								
	10:00-10:30	10:45-11:15	11:30-12:00	12:15-12:45	13:00-13:30	13:45-14:15	14:30-15:00	15:15-15:45
Aerospace Engineering			Room 209 Engineering Building		Room 209 Engineering Building			
Life Sciences: Sciences Underpinning Dentistry		People's Palace PP1				People's Palace PP1		
Life Sciences: Sciences Underpinning Medicine			People's Palace PP2				People's Palace PP2	
Biological Sciences	Drapers' Lecture Theatre			G.E.Fogg Lecture Theatre	Drapers' Lecture Theatre			G.E.Fogg Lecture Theatre
Biomedical Engineering				Room 216 Engineering Building				
Biomedical Sciences		People's Palace PP2		People's Palace PP2	People's Palace PP2	People's Palace PP2		People's Palace PP2
Business and Management			Francis Bancroft Mason Theatre				Francis Bancroft Mason Theatre	
Chemical Engineering		Room 209 Engineering Building					Room 216 Engineering Building	
Chemical Sciences		Drapers' Lecture Theatre			G.O. Jones Lecture Theatre			Drapers' Lecture Theatre
Comparative Literature					ArtsOne Lecture Theatre			
Computer Science		G.O. Jones Lecture Theatre					G.O. Jones Lecture Theatre	
Dentistry				People's Palace Great Hall				People's Palace Great Hall
Design and Creative Computing						Room 216 Engineering Building		
Drama		ArtsTwo Lecture Theatre					ArtsTwo Lecture Theatre	

SUBJECT TALKS								
	10:00-10:30	10:45-11:15	11:30-12:00	12:15-12:45	13:00-13:30	13:45-14:15	14:30-15:00	15:15-15:45
Economics and Finance		Francis Bancroft Mason Theatre				Francis Bancroft Mason Theatre		
Electronic Engineering				People's Palace PP1			People's Palace PP1	
English	ArtsTwo Lecture Theatre					ArtsTwo Lecture Theatre		
Environmental Science		Geography 126 Lecture Theatre				Geography 126 Lecture Theatre		
Film Studies			ArtsOne Lecture Theatre				ArtsOne Lecture Theatre	
Geography			Drapers' Lecture Theatre				Drapers' Lecture Theatre	
Global Health		G.E.Fogg Lecture Theatre				G.E.Fogg Lecture Theatre		
History				ArtsTwo Lecture Theatre				ArtsTwo Lecture Theatre
Information Technology Management with Business					Francis Bancroft Mason Theatre			
Languages		Languages Overview ArtsOne Lecture Theatre	Hispanics ArtsOne Room 1.28	German ArtsOne Room 1.28	Russian ArtsOne Room 1.28	French ArtsOne Room 1.28		
Law			People's Palace Great Hall				People's Palace Great Hall	
Linguistics							ArtsOne Room 1.28	
Materials Science						Room 216 Engineering Building		
Mathematical Sciences		Peston Lecture Theatre				Peston Lecture Theatre		
Mechanical and Sustainable Energy Engineering					Room 209 Engineering Building		Room 209 Engineering Building	
Medicine		People's Palace Great Hall				People's Palace Great Hall		
Physics and Astronomy				G.O. Jones Lecture Theatre				G.O. Jones Lecture Theatre
Politics and International Relations			ArtsTwo Lecture Theatre				ArtsTwo Lecture Theatre	
Psychology	G.E.Fogg Lecture Theatre		G.E.Fogg Lecture Theatre		G.E.Fogg Lecture Theatre		G.E.Fogg Lecture Theatre	
Robotics			Room 216 Engineering Building			Room 209 Engineering Building		
Science and Engineering Foundation Programme					Francis Bancroft David Sizer Theatre			



Recommended:

Our Life Sciences talks will provide an overview of the wide range of degrees that those interested in medical or dental subjects might consider studying; more details on each programme will be given in the subject-specific talks.



Tip:

Neuroscience is covered in the Biomedical Sciences talks.

In addition to the subject talks offered at the open day which give you an insight into what the course is about, our academic schools also offer a range of interesting taster lectures.

These lectures on specific topics will give you a flavour of what teaching is like here at Queen Mary and a sense of what lectures are like on your course. Our world-class academics hope to give you an insight into their topic and inspire you to go further.

What is Actuarial Science?

Jim Webber is a Lecturer in Actuarial Science and a qualified actuary with extensive industry experience. In this Taster Lecture he will provide an overview of the actuarial industry and career opportunities in this field, as well as introducing our BSc Mathematics with Actuarial Science degree programme.

Time: 11.30-12.00

Location: Peston Lecture Theatre ■

Chemistry is Kool

Come and explore the wonders of Chemistry - a central science that underpins many other science-based subjects including Medicine and Dentistry. This fun, interactive lecture will demonstrate the use of liquid nitrogen to condense oxygen from the atmosphere and use solid carbon dioxide to generate 'stage smoke' and coloured solutions of your favourite football teams.

Time: 11.30-12.00

Location: People's Palace 1 Lecture Theatre ■

Are CEOs paid too much?

The Barclays' CEO is expected to be paid £8.4 million a year. Why is he (and CEOs more generally) paid such large amounts of money? Should the government intervene and regulate how much CEOs are paid? Come to this talk if you would like to know the answers!

Time: 12.15-12.45

Location: Peston Lecture Theatre ■

Trusts of the Family Home

This talk addresses how the law of equity has adapted to social changes in the living arrangements of cohabiting couples (who are not in a relationship recognised by law), through recent decisions in the Chancery Court. Fancy a firefighter? What a difference a few words make!

Time: 12.15-12.45

Location: Laws Building 2.10 ■

Terrorism, Drones and Killer Robots: can war be ethical in the twenty-first century?

This lecture will focus on whether the changing nature and technologies of warfare affect how we should think about the morality of war. We will focus in particular on the use of drone strikes as a means of carrying out counter-terror and counter-insurgency operations. Are drones an 'ethical' weapon?

Time: 12.15-12.45 (FRIDAY ONLY)

Location: Mason Lecture Theatre ■

The Politics of Inequality in the U.S.

A review of the political and non-political causes of the growth of income inequality in the U.S., whose political system has been affected by the phenomenon to a greater extent than comparable developed states (excluding the UK). We'll consider whether aspects of the political system (two-party majoritarian) contribute to the polarisation of party politics and thereby contribute to the reproduction of inequality.

Time: 12.15-12.45 (SATURDAY ONLY)

Location: Mason Lecture Theatre ■

Maths, Murder and Malaria

Dr Steven Le Comber will explain how work at Queen Mary has shown how a statistical technique originally developed to prioritise investigations of serial murder can help to target the sources of infectious diseases including malaria and cholera - and can also help locate invasive species.

Time: 13.00-13.30

Location: Skeel Lecture Theatre ■

Bioelectronics and Energy Harvesting: a role for plastics

Scientists and engineers at QMUL are actively involved in developing plastic materials that are electrically conductive. This talk will introduce the research field and discuss how materials science is key to realising exciting applications.

Time: 13.45-14.15

Location: Skeel Lecture Theatre ■

Experimental Mathematics

State-of-the-art computer algebra systems have added an experimental dimension to the exact science of mathematics, allowing mathematicians to discover things that no-one could have previously imagined. In this Taster Lecture, Professor Franco Vivaldi will demonstrate the power of computer technology in mathematics.

Time: 13.45-14.15

Location: Peston Lecture Theatre ■

Co-ownership of Land

What happens when you buy a flat with a friend? Who is on the legal title and does it make any difference who contributed more or less? More to the point, if you want to sell your share of the flat, can you do that? And what is the advantage (or disadvantage) of death?

Time: 15.15-15.45

Location: Laws Building 2.10 ■

English and Drama Tasters

These taster sessions give you the chance to expand your mind in the fields of literature, theatre, creative writing, performance, culture and society. For more information about these sessions, please speak to staff from the School of English and Drama in the Arts Two Building Welcome Area. Places are limited but you can book your place in advance by emailing sed-admissions@qmul.ac.uk or book on the day at the School of English and Drama Welcome Area.

English – Friday 23 June

11.30-12.30	14.30-15.30
Witchy Women in Macbeth Location: Arts Two Building, 2.17	James Joyce's Ulysses: Writing Modern Consciousness Location: Arts Two Building, 2.17
'Liberty Freeing a Slave: William Blake's Songs of Innocence and Experience' Location: Arts Two Building, 3.16	John Donne's Poetry: Relationship Trouble Location: Arts Two Building, 3.16
Creative Writing Workshop: Experimenting with Voice Location: Arts Two Building, 3.20	The Popular, the Difficult, and the Ugly: From Mills and Boon to High Modernism Location: Arts Two Building, 3.20

Drama – Friday 23 June

11.30-12.30	14.30-15.30
Improvisation in Performance Location: Arts One Building - Pinter Studio	Improvisation in Performance Location: Arts One Building - Pinter Studio
Surveying the Sites Location: Arts One Building - Room RR1	Surveying the Sites Location: Arts One Building - Room RR1

English – Saturday 24 June

11.30-12.30	14.30-15.30
The Popular, the Difficult, and the Ugly: From Mills and Boon to High Modernism Location: Arts Two Building, 2.17	Happy Hour in Early-Modern London Location: Arts Two Building, 2.17
Introducing Literary Theory Location: Arts Two Building, 3.16	Radioactive Tonto: Native American Fiction and the Postcolonial Location: Arts Two Building, 3.16
Looking into The Bloody Chamber: Angela Carter's Freudian Imagination Location: Arts Two Building, 3.20	'Introducing Literary Theory' Location: Arts Two Building, 3.20

Drama – Saturday 24 June

11.30-12.30	14.30-15.30
Phakama's Map of the World Location: Arts One Building - Room RR3	Keeping the Plates Spinning? Location: Arts One Building - Pinter Studio
Keeping the Plates Spinning? Location: Arts One Building - Pinter Studio	Walking in the City Location: Arts One Building - Room RR1
Walking in the City Location: Arts One Building - Room RR1	

Map

Key

Buildings

- ArtsOne
- ArtsTwo
- Engineering
- Francis Bancroft
- G.E.Fogg
- Geography
- G.O. Jones
- Graduate Centre
- Laws
- Octagon
- People's Palace
- Joseph Priestley
- 👑 Registration marquee
- i Information Point

Tours and other activities

- 1 Campus Tours
- 2 Halls of Residence Tours
- 3 Library Information
- 4 Student Experience Fair
- 5 Sport and Student Societies
- 6 Students' Union Hub

Academic Welcome Areas

- School of Languages, Linguistics and Film**
ArtsOne Foyer
- University of London Institute in Paris**
ArtsOne and ArtsTwo Foyer
- School of Politics and International Relations**
ArtsTwo Foyer
- School of English and Drama**
ArtsTwo Foyer

- School of History**
First Floor Foyer, ArtsTwo
- School of Electronic Engineering and Computer Science**
Engineering Building Foyer (entrance via People's Palace Foyer or Mile End Rd)
- School of Engineering and Materials Science**
G27 Engineering (entrance via Bancroft Rd)
- School of Business and Management**
Francis Bancroft Foyer
- School of Economics and Finance**
Graduate Centre Foyer
- School of Medicine and Dentistry**
Francis Bancroft, First Floor, Room 1.13a

- Life Sciences: Sciences Underpinning Medicine and Dentistry**
Francis Bancroft, First Floor, Room 1.13a
- Biological, Biomedical Sciences and Psychology**
G.E.Fogg Foyer
- School of Geography**
Geography Building
- Chemical Sciences**
Joseph Priestly Foyer
- School of Physics and Astronomy**
G.O. Jones Foyer
- School of Mathematical Sciences**
Graduate Centre Foyer
- School of Law**
Law Building Foyer

Where to eat

- A World Food Festival Stalls
- B Ground Cafe
- C Village Shop and Drapers Bar
- D Mucci's
- E The Foyer
- F The Curve



Subject areas

Our academic Schools teach a range of subject areas related to their core disciplines. We also encourage cross collaboration between Schools to teach joint and related programmes. This means you may wish to visit more than one Welcome Area to hear about your chosen subject. We have put together a list of subject areas along with all the academic Schools involved with programmes that include them.

Subject Area	School
Foundation Programmes	• All Schools except Medicine and Dentistry
Actuarial Science	• Mathematical Sciences
Business Management and Accounting	• Business management and accounting • Business and Management • Electronic Engineering and Computer Science • Economics and Finance • Geography • Languages, Linguistics and Film • Mathematical Sciences • Politics and International Relations
Biological and Biomedical Sciences	• Biological, Biomedical Sciences and Psychology • Medicine and Dentistry
Chemical Sciences	• Chemical Sciences
Comparative Literature	• Languages, Linguistics and Film • History
Computer Science and Information Technology	• Electronic Engineering and Computer Science • Business and Management • Mathematical Sciences
Design	• Engineering and Materials Science • Electronic Engineering and Computer Science
Drama	• English and Drama • Languages, Linguistics and Film
Economics	• Economics and Finance • Business and Management • Politics and International Relations • Mathematical Sciences
Electronics, Telecommunications, Music and Audio Systems	• Electronic Engineering and Computer Science
Engineering	• Engineering and Materials Science • Electronic Engineering and Computer Science
Environmental Science	• Geography
Finance	• Economics and Finance • Business and Management • Mathematical Sciences
Geography	• Geography • Business and Management
Global Health, Medicine, Dentistry	• Medicine and Dentistry
History	• History • Languages, Linguistics and Film • English and Drama • Politics and International Relations
Information Technology Management for Business	• Electronic Engineering and Computer Science
Languages and Cultures	• Languages, Linguistics and Film • History • English and Drama • Business and Management • Politics and International Relations
Law	• Law • Politics and International Relations
Materials Science and Engineering, Biomaterials, Mechanical Engineering and Biomedical Engineering	• Engineering and Materials Science
Mathematics	• Mathematical Sciences • Business and Management • Economics and Finance • Electronic Engineering and Computer Science
Genetics and Medical Genetics	• Biological, Biomedical Sciences and Psychology
Multimedia and Arts Technology	• Electronic Engineering and Computer Science
Politics and International Relations	• Politics and International Relations • Business and Management • Languages, Linguistics and Films • History
Psychology and Neuroscience	• Biological, Biomedical Sciences and Psychology
Zoology	• Biological, Biomedical Sciences and Psychology

“Student Experience Fair is a must! I was worried about finance and learning support but the advice and info I got took my worries away!”



Student Experience Fair

Queen Mary offers a network of support services to ensure that you get the most out of your experience as a student here.

The Student Experience Fair will be open all day in the Octagon, so you can chat with staff from these services.

• Admissions

Our Admissions team can offer advice about the admissions process and selection criteria and are happy to discuss your application with you.

• Advice and Counselling Service

Advice and Counselling offer a range of free and confidential services to help students in a variety of situations – from the practical and legal to personal issues including student finance.

• Careers and Enterprise Centre

From finding a part-time job while studying, to securing your dream job after graduation, the Careers Service support our students with all aspects of careers information and guidance.

• Disability and Dyslexia Service

The Disability and Dyslexia Service offers support for all students with disabilities, specific learning difficulties and mental health issues.

• Global Opportunities

Our international exchange and Erasmus programmes offer a wide range of opportunities to study with our partners for a semester, a full year or a short summer programme.

• Learn a Language

Queen Mary offers the opportunity for its students to learn another language, these include: Arabic, French, German, Japanese, Mandarin, Spanish.

• Students' Union

Queen Mary Students' Union provides a number of student-run activities, like sports clubs, societies, student media and volunteering.

• Scholarships and Bursaries

Discover the financial support we offer at QMUL to help you with your studies.

Tours and other activities

General Campus Tours

General Campus Tours will be running all day from the Octagon. One of our Student Ambassadors will show you around and answer any questions you may have about life as a student at Queen Mary. Please note that the General Campus Tour does not include our accommodation, which can be seen on the Halls of Residence Tour.

The General Tour lasts 30-45 minutes and there may be a short wait for a tour at peak times.

Self-Guided Tour

If you would rather explore the campus independently, pop in to the General Campus Tours area in the Octagon, where you can pick up a Self-Guided Tour leaflet to help you find your way around.

Halls of Residence Tour

Halls of residence Tours will be running all day from the Student Village and are an opportunity to look around the place you might be calling home in a year's time. Tours will take approximately 20 minutes and staff will be on hand to answer any questions you may have.

Drapers Bar

Provides a relaxed and easy-going environment for students to take a break from work and socialise with friends.

Qmotion Sports and Fitness Centre

The sport & fitness centre for Queen Mary students. The facilities have been designed to accommodate a range of activities from group exercise classes through to performance training and qualified personal trainers.

Academic School Tours

Some academic Schools will be offering tours of their facilities throughout the day. Please ask in the relevant Welcome Area if a tour is being offered for your subject of interest.

Library

The Library will be open all day, with staff available to show you around the study space and subject collections, answering any questions you might have.

Get Active

Get Active is the Students' Union's fun, convenient and affordable sports programme. Over 40 sessions take place each week in a wide variety of different sports. Students are able to 'turn up and play' and also take part in organised leagues and tournaments.

Get Active will be running drop-in taster activities and competitions (including a climbing wall!) throughout the day in Library Square.

Some student societies will be showcasing their activities and societies too.

Scholarships and Bursaries

At Queen Mary University of London (QMUL) we are committed to ensuring that financial constraints do not hinder people from aspiring to attend university and we also recognise and reward excellence.

We offer a range of financial support for students studying at QMUL in the form of scholarships, bursaries and other awards. These are funded by the University, through partnerships with external organisations or through generous donations from alumni and friends of QMUL.

There are a number of sources of funding available and these include a significant package of competitive Queen Mary bursaries and scholarships in a range of subject areas, as well as external sources of funding.

The value of the awards varies depending on the scheme, and range from full scholarships to partial fee waivers.

All financial support opportunities have associated eligibility conditions such as household income or academic achievement. Some awards are competitive and require an additional application whereas others are automatically awarded based on your prior qualifications and conditions.

To find out more about the financial support we offer, please visit our Scholarships and Bursaries stand at the Student Experience Fair in the Octagon inside the Queens' Building today.

You can also visit our website at: qmul.ac.uk/scholarships for further information.

Making a difference

"I can't express how amazing it feels to receive the International Science and Engineering Excellence Award. This scholarship helped ease the financial pressures of school and allowed me to place all my focus on becoming the best student I can be. The lectures are insightful and all the faculty and staff are helpful. London is one of the best cities in the world and am really grateful for this opportunity. Studying in the heart of UK has been a truly a mesmerising experience."

Muhammad Sarman Nadeem, Mechanical Engineering student

"I am a second year undergrad at Queen Mary University London. I am very grateful for the scholarship, it gave me a great opportunity to learn from leading experts in their fields thus making study engaging and fun. I have been able to share my own culture while learning from others, QMUL has a welcoming environment."

Jorge Zúñiga, Electronic Engineering student



"It was great talking to staff and students in a relaxed environment. They were very welcoming and answered all my questions."



The Parents and Carers Guide to Higher Education

Making the decision about going to university involves all the family, so it's important that everyone knows what the process involves, including parents and carers.

There are a number of ways that you can support your son or daughter to make important decisions that will have a lasting effect on their lives.

Right now there might be a number of questions on your mind like how should you choose a university? Should your son or daughter live at home and travel to university or live on campus?

What course should they study? Should they have a particular career in mind? How do they apply and what's the UCAS

process like? How much will the course and accommodation cost? What support is available to them?

Don't worry. As a parent, you will appreciate that going to university is a life-changing opportunity. At Queen Mary we appreciate how daunting the prospect of letting go of your little one (well, they were little once!) can be. We can offer you useful advice and guidance to support you through your loved one's journey to university.

We have developed a guide to help take you through the whole process of how your son or daughter can choose and apply for the right course, understand student finance and make the most of student life.

You can pick up your copy from the information stand in Library Square or ask at the registration marquee.

If you'd like to keep in touch with us and receive useful information throughout the year, you can sign up to our Parents Scheme by completing a postcard available from the information point in Library Square and School Welcome Areas.

Investing in your future: investing in our campuses

Queen Mary University of London offers access to unparalleled state of the art teaching and research facilities in London which you will see during your visit today. But we are going further, investing in all of our campuses, and during your visit to the Mile End campus you will see several buildings undergoing exceptional transformations.

Graduate Centre

We opened our new building, the Graduate Centre, in January 2017. In addition to being the home for the School of Economics and Finance, the Doctoral College and the Research Degrees Office are located in the building. The Graduate Centre also provides work areas and social spaces tailored specifically to the needs and working patterns of our postgraduates.

The £39m building was completed in late 2016. It offers:

- An impressive 200-seat lecture theatre and numerous seminar rooms
- 7,700 square metres of new learning and teaching space including a 'mock trading floor'
- A new landscaped courtyard
- New trees, planting, green walls and areas of greenery
- A ground floor café, with seating inside and out

Engineering Building

A major £30 million redevelopment over the next three years to modernise and enhance the building and facilities of the Engineering Building, used by the School of Engineering and Materials Science and the School of Electronic Engineering and Computer Science, is also underway. The first phase of work has been completed including undergraduate teaching space, a human performance lab and a robotics engineering lab. Further work will include the development of a creative engineering hub and a brand new robotics engineering lab.

Mathematics Building

The School of Mathematical Sciences is investing approximately £19 million in a transformative project to create an inspiring, collaborative space for our community of students and staff.

As well as high-quality teaching space there will be a range of private and group study areas throughout the building, and a new social space to provide an informal hub. The project is expected to be completed in 2019.



Graduate Centre

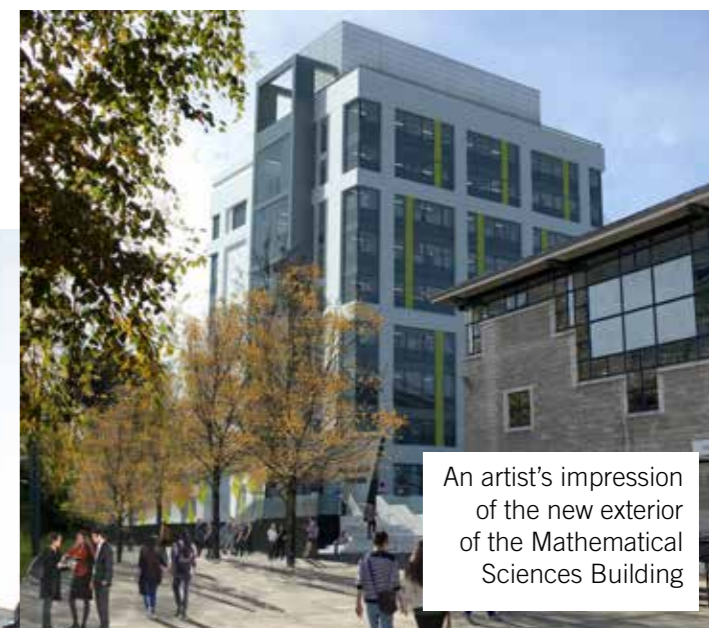

An artist's impression of the new exterior of the Mathematical Sciences Building



Peston Lecture Theatre

Celebrating 130 years of Queen Mary University of London (QMUL)

This year, we're celebrating QMUL's 130th anniversary, and are proud to continue our historic commitment to educating the best and brightest individuals regardless of their background.

Our heritage can be traced back to the late 19th century with the establishment of the People's Palace, a philanthropic organisation designed to bring culture, recreation and education to the East End.

A striking feature of Mile End Road, the Palace was a collaborative project funded largely by the Beaumont Trust and the Drapers' Company. It delighted the local community with a vibrant calendar of social events and facilities including swimming baths, concert halls and a sublime Winter Garden.



From industry to academia

The People's Palace also established Technical Schools to train a new generation of tradespeople for east London; however, many students excelled at their studies and progressed into further academia, demonstrating a significant need for local opportunities in higher education.

As the success of the People's Palace Technical Schools continued to grow, arts and humanities teaching was introduced – and this commitment to academic excellence led to the Schools' permanent admission to the University of London in 1915 under the new name of East London College (ELC).

Becoming Queen Mary

By 1934, the College's influence and reputation had developed beyond the capital: students came not only from across Britain, but the globe. Awarded a Royal Charter by Queen Mary of Teck, ELC took the name Queen Mary College in her honour, and began to expand its facilities, partnerships and achievements.

The latter half of the 20th century brought a merger with Westfield College, an early pioneer of women's education, and the globally recognised medical schools of St Bartholomew's and The (Royal) London Hospitals.

QMUL today

With more than 21,000 students, QMUL's teaching and research stretches across three faculties: Humanities and Social Sciences, Science and Engineering, and Barts and The London School of Medicine and Dentistry. Now a leading Russell Group university, we were ranked 9th in the UK for the quality of our research (Research Excellence Framework 2014) and continue to facilitate leading studies ranging from the discovery of exoplanet Proxima b to understanding the psychology of bumblebees.

We are proud that our vibrant and diverse community of staff and students are not only renowned for their academic ability, but their demonstrable commitment to public good.

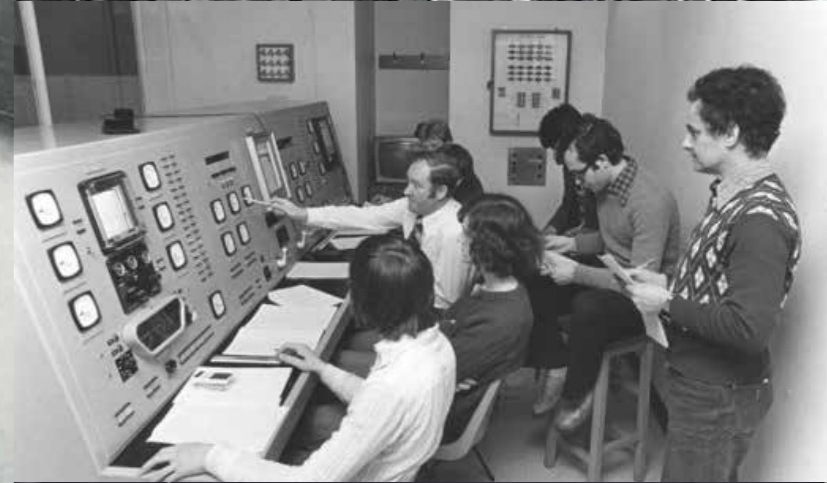
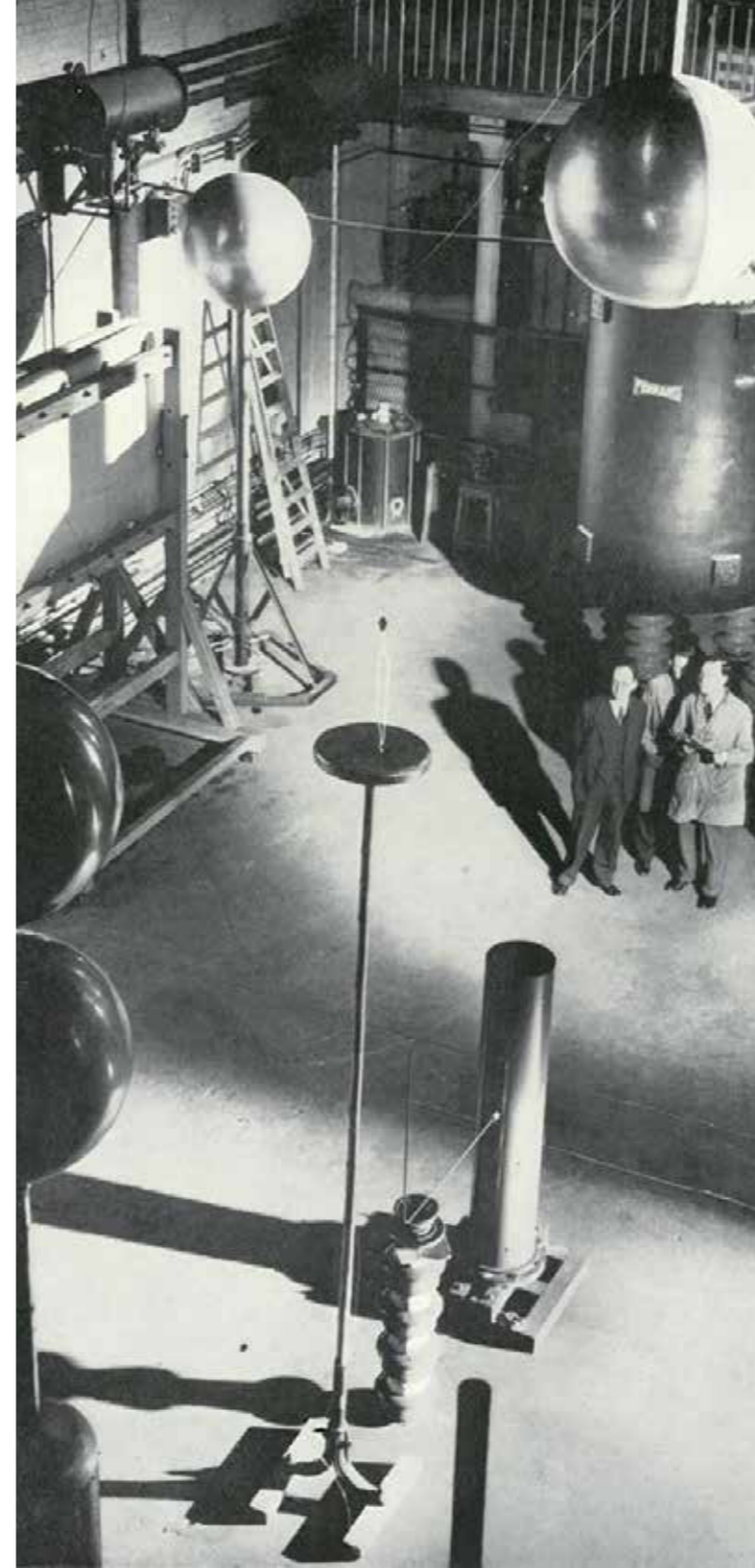

Queen Mary Students' Union – Get involved!



Who Are We?

Queen Mary Students' Union is a democratic membership organisation that is the voice of all Queen Mary students. The Union ensures that the College and the wider community are listening to what students want and works to improve students' experience. The Union is led by students across Queen Mary. Every student is automatically a member of the Union and has a say in how it is run through elections and their representatives.

The Union provides a number of student-run activities, like sports clubs, societies, student media and volunteering. The Students' Union also offers student-led events and services in Mile End and Whitechapel including a sport and fitness centre and several shops and venues.

The Hub

This is where you can find information about local and campus events, arrange to meet your Sabbatical Officers or members of staff, make appointments for advice and find out about volunteering opportunities. The Hub is located on the Mile End campus and you can come and have a look the facilities today (number 6 on the campus map).

Clubs, societies and the community

The Students' Union has over 190 different clubs and societies, so whether you are interested in football, politics, martial arts or theatre, you should be able to find something to suit your interests. You can also develop your skills through student community action projects or volunteering opportunities.

Qmotion and other sports facilities

The Union's state-of-the-art Health and Fitness Centre, Qmotion and is fitted with the latest equipment. As well as the sports facilities on campus, you can also use facilities off-site. Come and visit us today (see campus map) and get involved with activities in Library Square.

Entertainment

A packed social calendar keeps students on their toes with regular nights and seasonal one-off events. The Drapers' Bar in Mile End is one of the best student entertainment venues in the country (see campus map). Medical and dental students can also make use of entertainment facilities at Whitechapel and Charterhouse Square.

For more information, visit us in the Student Experience Fair in the Octagon or at the Hub today.

Get Active - Sport at Queen Mary

At Queen Mary, we provide a huge variety of sports and activities for complete beginners up to elite athletes. Get involved with our fun and social 'turn up and play' programme, or challenge yourself to compete against other universities nationwide. There are also plenty of opportunities to develop your coaching skills as a sports leader.

Get Active

Get Active is our social sport programme offering 40 sessions per week in a variety of sports from Badminton to Archery. All equipment is provided and no previous experience is necessary. Get Active is a great way to keep fit and make new friends so get involved and give it a go!

Sport Leagues

The Sport Leagues offer a social environment to compete in sport without the commitment required for a sports club. Enter a team from your hall, friends, course-mates or society and take part in Football, Basketball, Cricket, Netball, Tennis or Squash. All leagues take place either on or near campus. The leagues are open to all abilities and fees include fixtures, officials, facilities and equipment.

Community Sport

This is an award-nominated sports leadership programme that deploys students into voluntary coaching and refereeing positions within local community sport. The programme is designed to give you the best possible opportunities to develop your CV with fantastic experience, skills and qualifications to ensure you get the most out of your time at university.

Elite Athlete Programme

The Elite Athlete Programme enables student athletes to focus on their studies, training and competition and worry less about the financial barriers and administration that comes with performing at an elite level.

Club Sport

Whether you're looking to continue taking part in a sport or you want to explore a new one, there are plenty of opportunities within Club Sport for you to get involved. Clubs are run by students for students.

To find out more about sport at Queen Mary, please speak to our Students' Union staff who will be available in Library Square, the Student Experience Fair and in the Qmotion Sport and Fitness Centre.



Student Accommodation

We have one of the largest residential campuses in the capital, with a 2,000-bed Student Village at Mile End. Living on campus is fun, safe and convenient – you'll only be a five-minute walk to your lectures – perfect for those 9am starts. It's also a great – and affordable – chance to live in London.

All of our accommodation is in self-catered flats and maisonettes. We also have dedicated halls for medical and dental students situated in Dawson Hall at the Charterhouse Square campus and in Floyer House at the Whitechapel campus. As a Queen Mary student, you also have the opportunity to live in the fully catered University of London (UoL) Halls in central London, alongside students of other UoL colleges.



We can provide specialist advice on a range of alternative housing including: renting a local room or flat, a room in a privately built hall of residence or choosing a homestay or short-stay option (which provides greater flexibility).

For more information about applying for our housing, as well as further guidance and information on prices and tours, please visit the Residences Team today at the Student Village (point '2' in the campus map).

You can also contact us on: Tel: +44 (0)20 7882 6474
email: residences@qmul.ac.uk, residences.qmul.ac.uk



East London: The Soul of the Capital

Projecting a vibrant blend of colours and landscapes, Mile End and Whitechapel are some of London's most imaginative districts. Located in the heart of east London, they are home to a vivid mixture of cultures and people from across the world.

This global personality resonates within everything you see, from the people to the businesses and from the food through to the markets. The architecture is a mix of the quaint and the modern, striking a great balance of traditional East End character and contemporary cool across the Victorian churches, pubs, museums and the world-class sports facilities and parks.

The East End is one of the most rapidly changing parts of the capital and with so much creativity and innovation around you, it's hard not to be inspired by everything you experience.

Mile End and Whitechapel sit at the doorstep of Central London, with Canary Wharf, Stratford and Shoreditch offering an abundance of opportunities for students. With its world famous nightlife, festivals, sport, shops and access to industry, London and the East End is an inspiring place to live and study. And when you combine all this with a welcoming community, full of the famous East End spirit, east London will soon become a place that will quickly feel like home.



Pick up a copy of our students' guide to east London in Library Square

London landmarks:

- Queen Elizabeth Olympic Park – 1.8 miles/2.9km
- Canary Wharf – 1.9 miles/3km
- Tower of London – 2.3 miles/3.7km
- St Paul's Cathedral – 2.8 miles/4.5km
- Tate Modern – 3 miles/4.8km
- Trafalgar Square – 4.3 miles/6.9km
- Big Ben – 4.6 miles/7.4km
- London Eye – 4.7 miles/7.5km
- Oxford Circus – 4.9 miles/7.8km
- Buckingham Palace – 5.1 miles/8.2km

On your doorstep (in walking times)

- Sainsbury's supermarket – 30 seconds (30 yards/27m)
- Tube station (Mile End) – 5 minutes (352 yards/322m)
- Climbing wall – 7 minutes (704 yards/644m)
- Mile End Park Leisure Centre, with swimming pool, sports pitches and athletics track – 8 minutes (0.5 miles/0.8km)
- Independent cinema (Genesis) – 8 minutes (0.6 miles/0.9km)
- One of the best Punjabi restaurants in London (Tayyabs) – 18 minutes (1.2 miles/1.9km)
- One of the best contemporary art galleries in Europe (Whitechapel Gallery) – 22 minutes (1.5 miles/2.4km)
- A fresh bagel any time of the day or night (Brick Lane) – 25 minutes (1.8 miles/2.9km)
- Heated outdoor pool all year round (London Fields Lido) – 30 minutes (2 miles/3.2km)

World Food Festival

The World Food Festival is a street food festival dedicated to showcasing the very best and most creative street food traders and celebrating the amazing multiculturalism of London's street food scene. We are pleased to be hosting these artisan caterers on our campus, allowing our visitors to experience a taste of the world.

You have a wide selection of cuisine to choose from which should satisfy even the most exotic of palates so make sure you stimulate your taste buds before you leave today!

The cuisine on offer includes European, South Asian, Far Eastern, South American and Caribbean.

The festival stalls are located across two locations on the campus. Please refer to points 'A' on the map or ask staff for directions.



"Open Days at QMUL are different. Not only did I get all the information about my degree, but I also had so much fun getting it"



We hope you have a great day with us.

Top 5 Things To Do

- Visit your Academic Welcome Area and attend subject talks
- Tour the campus and student residences
- Visit the Student Experience Fair in the Octagon
- Check out our state-of-the-art Library
- Grab a bite from the World Food Festival

Other sites and sounds:

- Listen to the Principal's Welcome Talk
- Listen to an interesting Taster Lecture
- Take a pic at our cool photo booth in Library Square
- Take part in a spot of sports in Library Square
- Tour the QMotion Fitness Centre in Godward Square

Open Day Planner

What & When?	_____
Where?	_____
What & When?	_____
Where?	_____
What & When?	_____
Where?	_____
What & When?	_____
Where?	_____
What & When?	_____
Where?	_____
What & When?	_____
Where?	_____
4pm	_____
End of the Open Day	_____

Undergraduate Open Day

Thanks for attending our open day.

We hope that you found it enjoyable and informative.

Tell us what you think

Help us to improve the open day experience. We will send you an email with a link to our questionnaire if you'd like to provide your feedback. You will have the opportunity to enter a prize draw to be in for a chance to **win one of six £50 Amazon vouchers.**

Good luck!

The information given in this publication is correct at the time of going to press. The university reserves the right to modify or cancel any statement in it and accepts no responsibility for the consequences of any such changes. For the most up-to-date information, please refer to the website qmul.ac.uk



This programme has been printed on environmentally friendly material from well-managed sources.

Once you have finished with this please give it to someone else or recycle it.



Accredited by the
BRITISH COUNCIL



WORLD 100
REPUTATION NETWORK